

**Pri-Med Mid-Atlantic 2008
Sales Plan**
December 4 - 6, 2008
The Baltimore Convention Center
Baltimore, MD
Halls C,D, E, F & Swing Space

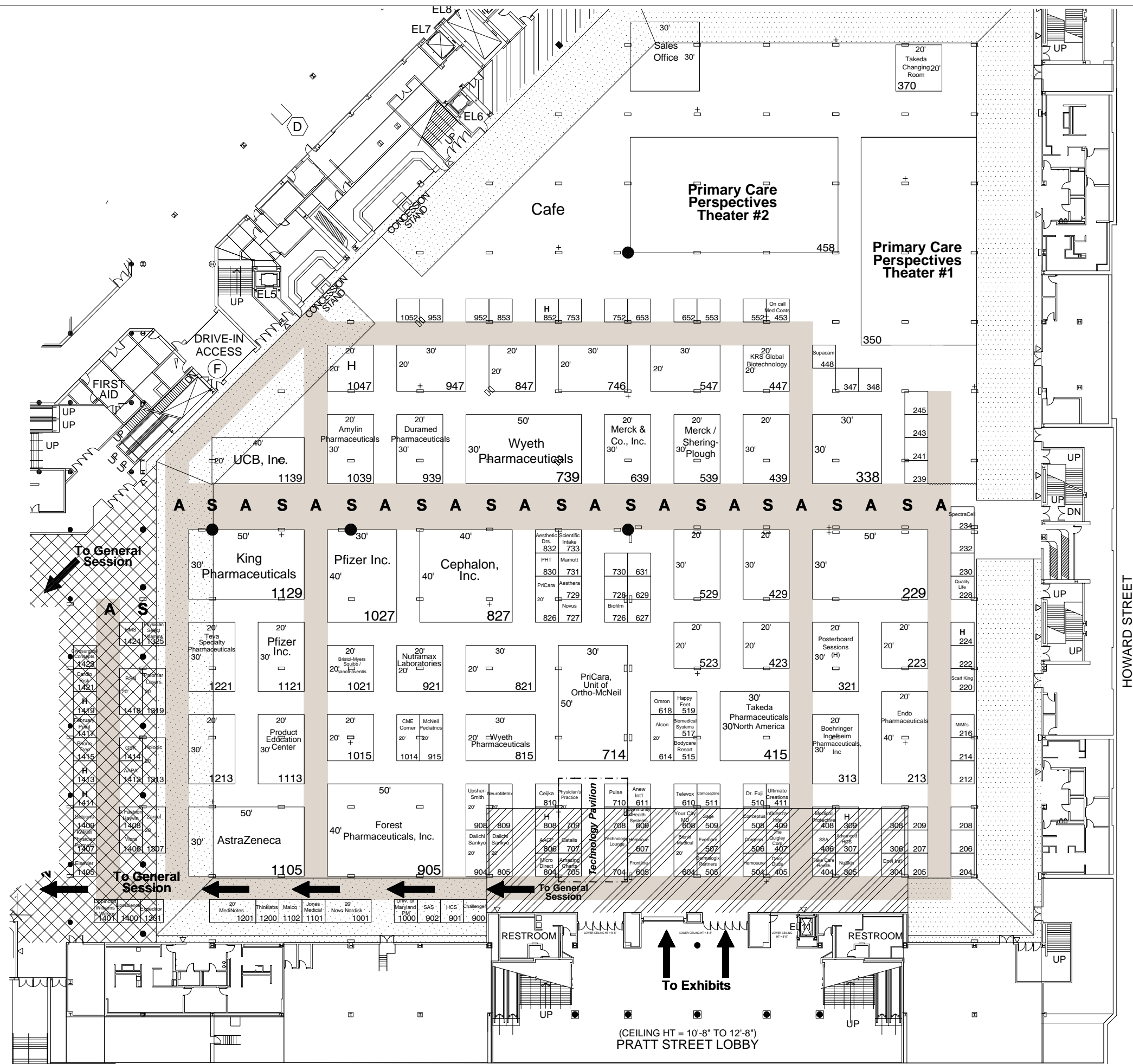

CEILING LEGEND

	12'-0" CEILING HEIGHT
	14'-6" CEILING HEIGHT
	15'-6" CEILING HEIGHT
	16'-6" CEILING HEIGHT
	18'-2 1/2" CEILING HEIGHT
	SLOPED CEILING FROM 18'-0" TO 31'-0"
	29'-0" CEILING HEIGHT

LEGEND:

Pri-Med Max Height is 20ft.
SLOPED CEILING FROM 18'-0" TO 31'-0"

Pri-Med Max Height is 8ft in 10' ceiling area.

SYMBOLS:

- FIRE STATION
- OPERABLE WALL
- ELECTRICAL FLOOR BOX
- AIR, WATER, AND DRAIN FLOOR BOX
- DOCK LEVELER
- TRUCK LIFT
- LAST IN - FIRST OUT

NOTES:

- 1) DO NOT BLOCK ANY SWINGING DOORS SHOWN ON THE PLANS.
- 2) DO NOT BLOCK ANY FIRE STATIONS SHOWN ON THE PLANS.
- 3) ALL AISLES ARE A MINIMUM WIDTH OF 10'-0", UNLESS OTHERWISE NOTED.

